

GUHRING

NEW: TSG 3000
The next generation shrink fit
chucks from Guhring



ML
by GÜHRING
.....

Thermo Secure Gold 3000

The high-end shrink fit chuck from Guhring

- perfect concentricity thanks to length setting screw with axial force damping
- 6 locating bores for highest balance
- maximum operational safety with optical temperature indicator
- optimal corrosion protection due to coating
- standard range for HSK-A, ISO taper and MAS-BT

2010 edition

NEW

Thermo Secure Gold 3000 No fear of high temperatures

NEW

Temperature indicator
provides protection

Up until now one couldn't tell a chuck's temperature. With the optical temperature indicator on Guhring Thermo Secure Gold 3000 chucks this source of danger is a thing of the past.

A red ring signals:
Attention, hot! Risk of burning!
The chuck has a temperature above
appr. 45° C.

When the temperature drops below
appr. 45° C, the ring turns blue.
The chuck can now be held without
danger. With a shrink fitted tool
optimal clamping is now achieved.

NEW

Coating
protects surface

A coated shrink fit chuck - of course! The PVD-coating provides outstanding corrosion protection and prevents the tarnishing of the chuck when heating and cooling. In addition, it counteracts contamination that occurs on conventional shrink fit chucks i.e. with cast iron, graphite and MQL machining. Subsequently, it ensures a longer chuck life.

Thermo Secure Gold 3000 with temperature indicator for maximum operational safety

1. Shrink fitting:
The chuck is heated
up in the shrink fit
system. Due to the
radial expansion the
tool can be inserted.

2. Red ring:
The chuck is hot fol-
lowing shrink fitting
for insertion. Risk of
burning!



**3. Putting on the
cooling adapter:**
Through controlled
cooling of the chuck
the tool is securely
clamped.

4. Blue ring:
The cooling procedure
is completed. The chuck
now has a temperature
below appr. 45° C.



5. Finished:
The tool and holder
can be removed from
the shrink fit system
without danger and
applied.



Thermo Secure Gold 3000

Length setting screw with axial force damping

When shrink fitting, the heating and subsequent cooling of the chuck and tool not only causes the desired radial shrinking but also the unwanted axial shrinking. If the clamped tool is sitting on the setting screw, it can result in small inaccuracies in tool concentricity with conventional solutions. The new length setting screw with axial force damping from Guhring completely offsets this axial length difference through the integrated, flexible compensating element. The length setting screw with axial force damping can be retrofitted to conventional Guhring chucks on request!



Thermo Secure Gold 3000 6 locating bores for highest balance

An imbalance produces a centrifugal force which is detrimental to the smooth running of the cutting tool. The consequence is a deterioration of the machined feature as well as a shorter tool life. Compensating to eliminate the imbalance completely is crucial for highly accurate machining.

Thanks to the six balancing holes of the new Thermo Secure Gold 3000 an imbalance – in contrast to conventional holders with four balancing holes – can be compensated with pinpoint accuracy, easily and with total reliability.

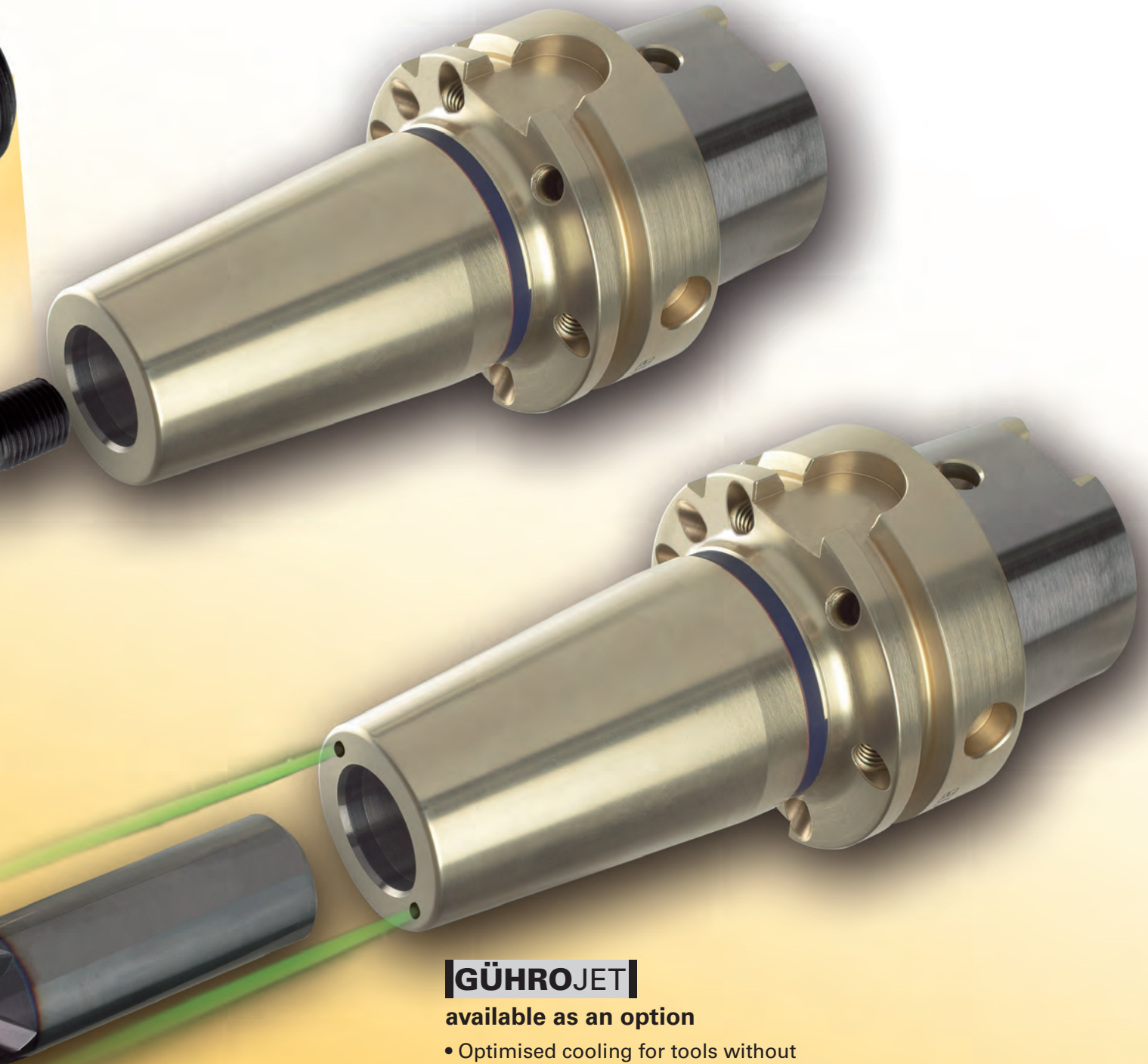

GÜHROJET

available as an option

- Optimised cooling for tools without internal coolant ducts
- Good chip evacuation and increased process reliability

Product information

- coating for protection against oxidation, cleanliness and longevity
- safety colour ring for maximum operator safety
- with axial damping screw for optimal concentricity
- MQL suitable
- for tool shank tolerance h6
- to DIN 69882-8
- balancing quality G6.3 at 15,000 rev./min
- designed with 6xM6 balancing screws for the highest accuracy

Scope of delivery

- incl. setting screw, Guhring no. 4941
- for conventional cooling order coolant delivery set, Guhring no. 4949, separately
- for MQL application order as special tool holder with coolant delivery set
- special dimensions on request

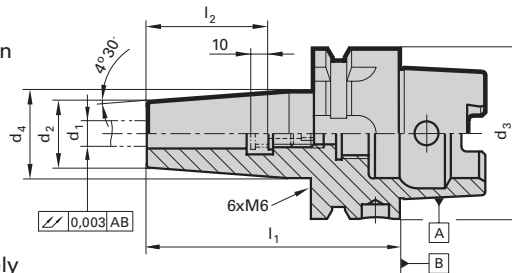
Guhring no.
4726

HSK-A d3	for clamping-Ø d1 h6 mm	d2 mm	d4 mm	l1 mm	l2 mm	incl. setting screw Guh.no. Code no.	kg	Code no.	Availability
63	6	21	27	80	36	4941 6,100	1.00	6,063	•
63	8	21	27	80	36	4941 8,100	1.00	8,063	•
63	10	24	32	85	41	4941 10,100	1.00	10,063	•
63	12	24	32	90	46	4941 12,100	1.00	12,063	•
63	14	27	34	90	46	4941 14,100	1.00	14,063	•
63	16	27	34	95	49	4941 16,100	1.00	16,063	•
63	18	33	42	95	49	4941 18,100	1.00	18,063	•
63	20	33	42	100	51	4941 20,100	1.00	20,063	•
63	25	44	53	115	57	4941 25,100	2.00	25,063	•
63	32	44	53	120	61	4941 32,100	2.00	32,063	•
100	6	21	27	85	36	4941 6,100	2.00	6,100	•
100	8	21	27	85	36	4941 8,100	2.00	8,100	•
100	10	24	32	90	41	4941 10,100	2.00	10,100	•
100	12	24	32	95	46	4941 12,100	2.00	12,100	•
100	14	27	34	95	46	4941 14,100	2.00	14,100	•
100	16	27	34	100	49	4941 16,100	2.00	16,100	•
100	18	33	42	100	49	4941 18,100	2.50	18,100	•
100	20	33	42	105	51	4941 20,100	2.50	20,100	•
100	25	44	53	115	57	4941 25,100	3.00	25,100	•
100	32	44	53	120	61	4941 32,100	3.00	32,100	•

ISO taper shrink fit chucks DIN 69871 form AD/B TSG 3000

Product information

- coating for protection against oxidation, cleanliness and longevity
- safety colour ring for maximum operator safety
- with axial damping screw for optimal concentricity
- for ISO40 to DIN 69871 form AD/B
- balancing quality G6.3 / 15,000 rev./min
- designed with 6xM6 balancing screws for the highest accuracy
- form B supplied with threaded pins in bores.
- for tool shank tolerance h6

Scope of delivery

- incl. setting screw Guhring no. 4941 for wet application
- order draw bolt Guhring nos. 4925, 4926 separately
- special dimensions on request
- ISO 50 on request
- order as special holder for MQL application

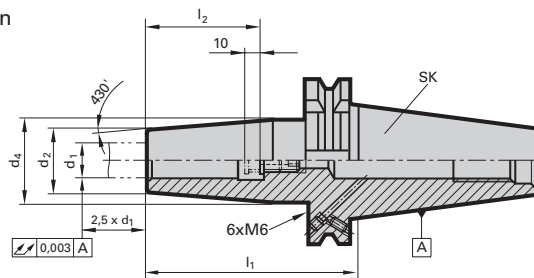

Guhring no.

4727



SK	for clamping-Ø d1 h6 mm	d2 mm	d4 mm	l1 mm	l2 mm	incl. setting screw Guh.no. Code no.	kg	Code no.	Availability
40	6	21	27	80	36	4941 6,041	1.00	6,040	•
40	8	21	27	80	36	4941 8,040	1.00	8,040	•
40	10	24	32	80	41	4941 10,050	1.00	10,040	•
40	12	24	32	80	46	4941 12,100	1.00	12,040	•
40	14	27	34	80	46	4941 14,100	1.00	14,040	•
40	16	27	34	80	49	4941 16,100	1.00	16,040	•
40	18	33	42	80	49	4941 18,100	1.00	18,040	•
40	20	33	42	80	51	4941 20,100	1.50	20,040	•
40	25	44	53	100	57	4941 25,100	1.50	25,040	•
40	32	44	53	100	61	4941 32,100	1.50	32,040	•

MAS-BT shrink fit chucks TSG 3000

Product information

- coating for protection against oxidation, cleanliness and longevity
- safety colour ring for maximum operator safety
- with axial damping screw for optimal concentricity
- MAS BT to JIS B 6339
- for tool shank tolerance h6
- balancing quality G6.3 / 15,000 rev./min
- designed with 6xM6 balancing screws for the highest accuracy

Scope of delivery

- incl. setting screw Guhring no. 4941 with axial force damping
- order draw bolt Guhring no. 4927, 4928 separately

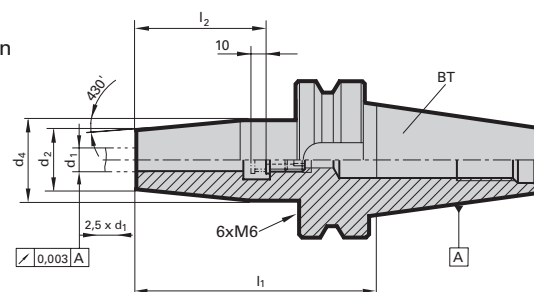

Guhring no.

4728



BT	for clamping-Ø d1 h6 mm	d2 mm	d4 mm	l1 mm	l2 mm	incl. setting screw Guh.no. Code no.	kg	Code no.	Availability
40	6	21	27	90	36	4941 6,041	1.00	6,040	•
40	8	21	27	90	36	4941 8,040	1.00	8,040	•
40	10	24	32	90	41	4941 10,050	1.00	10,040	•
40	12	24	32	90	46	4941 12,100	1.00	12,040	•
40	14	27	34	90	46	4941 14,100	1.50	14,040	•
40	16	27	34	90	49	4941 16,100	1.50	16,040	•
40	18	33	42	90	49	4941 18,100	2.00	18,040	•
40	20	33	42	90	51	4941 20,100	2.00	20,040	•
40	25	44	53	100	57	4941 25,100	2.00	25,040	•
40	32	44	53	100	57	4941 32,100	2.00	32,040	•

Drilling



Tapping/thread milling/fluteless tapping



Reaming



Countersinking/de-burring



Milling



PCD/PCB



Modular tooling systems



Special tooling solutions



Tool restoration service



GUHRING

Guhring oHG

P.O. Box 100247 · D-72423 Albstadt
Herderstr. 50-54 · D-72458 Albstadt

Telephone: +49 74 31 17-0

Fax: +49 74 31 17-21 2 79

www.guehring.de

No liability can be accepted for printing errors or technical changes of any kind.
Our Conditions of Sale and Terms of Payment apply. Available on request.